

FLOATING HEADER INSTALLATION INSTRUCTIONS

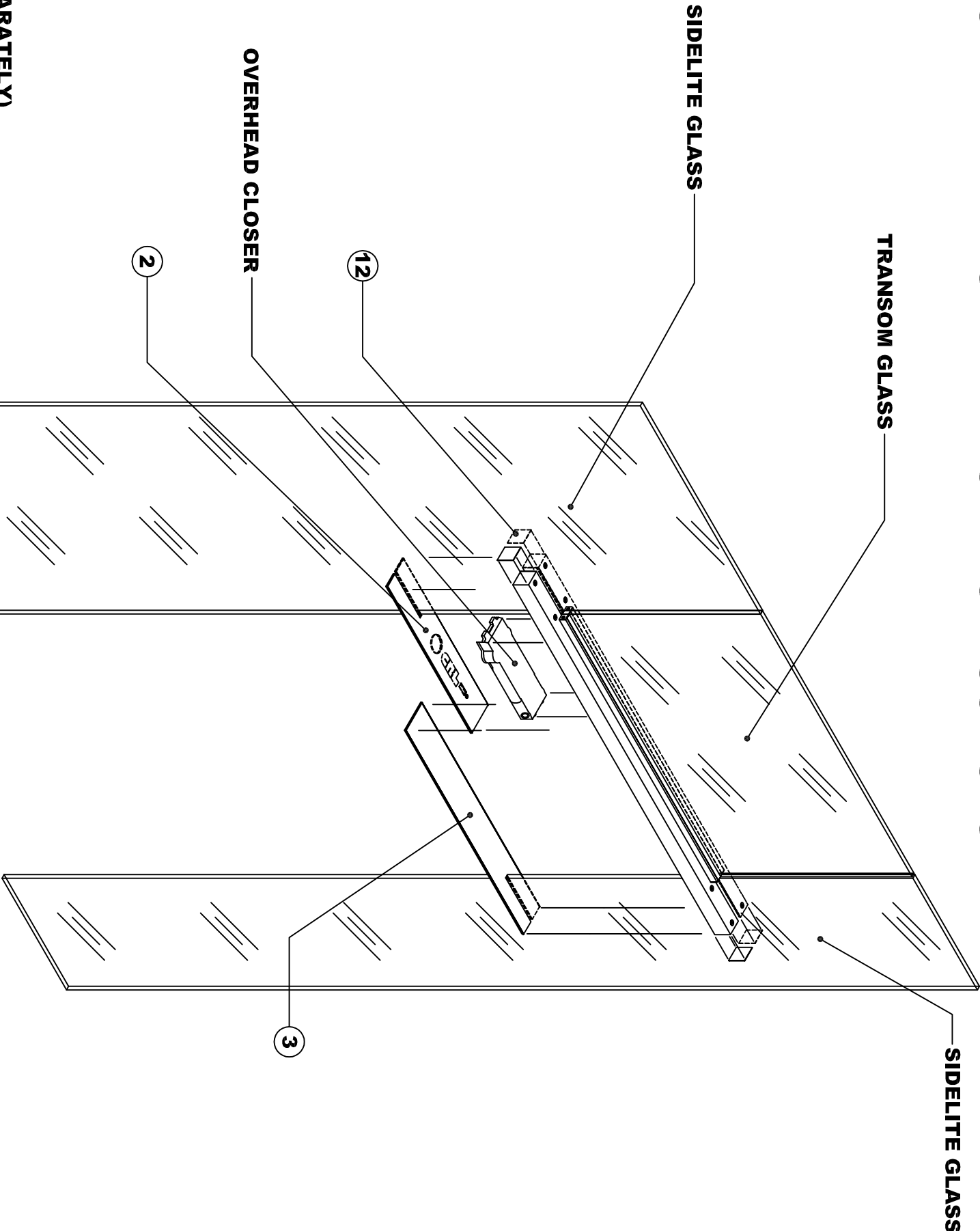

- PROCEDURES:**
- 15 INSTALL OVERHEAD CLOSER. (SOLD SEPARATELY) SEE CLOSER INSTALLATION INSTRUCTIONS.
 - 16 INSTALL SNAP FIT CLOSER COVER PLATE ② AND HEADER COVER PLATE ③.
 - 17 REMOVE BACKING PAPER FROM UHB TAPE ON THE 4 END CAPS ⑫ AND AFIX THEM TO THE ENDS OF THE HEADER

C.R.L. FLOATING HEADER SYSTEM

C.R. Laurence Architectural Products
Phone Orders (800) 421-6144
Fax Orders (800) 262-3299
www.crlaurence.com

No	DESCRIPTION	QTY
1	FLOATING HEADER ASSEMBLY	1
2	CLOSER COVER PLATE	1
3	HEADER COVER PLATE	1
4	TRUSS HEAD SCREWS	8
5	OUTSIDE CLAMP BLOCK	2
6	INSIDE CLAMP BLOCK	2
7	GLASS GROMMET	4
8	HEX HEAD SCREW	4
9	CLOSER END PLATE	1
10	SOCKET HEAD SCREW	2
11	FIBER GASKET	1
12	END CAP	4
13	GLAZING GASKET	2